



OPERATING MANUAL

BEAUTY LINE

Filter system

FOR A BETTER WORKBENCH ENVIRONMENT



FILTRONIC AB

Hissgatan 2, Box 2284, 531 02 LIDKÖPING

Tel: 0510-208 10, Fax: 0510-201 40

e-mail: office@filtronic.se

www.filtronic.se

Version 2
2009.03.16



Table of contents

| | | |
|-----|-------------------------|-----|
| 1. | Introduction | 2 |
| 2. | Content | 2-4 |
| 3. | Safety instruction | 4 |
| 4. | Put into operation | 5 |
| 5. | Management | 6 |
| 6. | Troubleshooting | 7 |
| 7. | Maintenance and service | 8-9 |
| 8. | Technical data | 9 |
| 9. | Article number | 10 |
| 10. | Assessories | 10 |
| 11. | Warranty | 11 |

1. Introduction

Filtronic's Beauty Line Nail Station is a mobile filter system that cleans the air from pollution which occurs around nail therapists and manicures.

2. Content

- 1 Hose connections
- 2 End cap
- 3 Front
- 4 Main filter
- 5 Power intake with fuse and circuit breaker

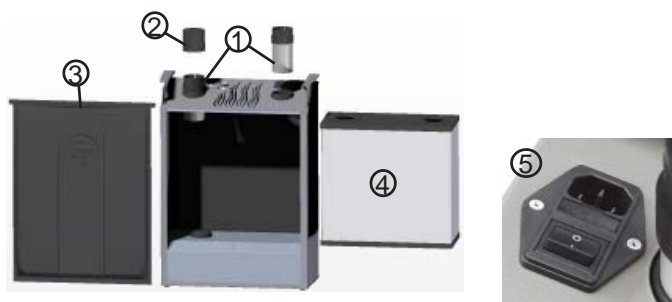

Control panel:

- 6 Push button - decrease blower capacity
- 7 LED indicator - low airflow
- 8 LED indicator - filter time exceeded
- 9 LED indicator - operation
- 10 Push button - increase blower capacity/restore the alarm
- 11 Intake for remote control

11. Warranty

General conditions according to ORGALIME S 2000.

Filtronic AB guarantees the product for manufacturing failures for a time period of two (2) years on filter units and accessories, consumptions not enclosed. The time is measured from date of invoice.

Only use genuine Filtronic AB consumables and spare parts in order to ensure reliable function and to maintain the unit's warranty. Repairs must be performed by personnel trained by Filtronic AB.

The information given is not binding and does not free the user from his or her responsibility to check the equipment before using it.

Filtronic AB reserves the right to introduce technical changes in the course of product development.

Always contact the supplier before return a product.
The invoice has to be shown at the time of the complaint.

10. Accessories



700-3057
Remote control



3046
Extraction arm 3046

Connection details Beauty Line No1:

- B Extraction arm 0F10
- C Nozzle N
- D Additional mainfilter
- F Hose connection with quick connection x 2
- G End cap
- H Power cord



Connection details Beauty Line No2:

- B Extraction arm 0F10 x 2
- C Nozzle N x 2
- D Additional mainfilter
- F Hose connection with quick connection x 2
- G End cap
- H Power cord



Connection details Beauty Line No 3:

- A Extraction arm 3415
- C Nozzle N
- D Additional mainfilter
- E Connection hose
- F Hose connection with quick connection x 2
- G End cap
- H Power cord

Connection details Beauty Line No 4:

- A Extraction arm 3415 x 2
- C Nozzle N x 2
- D Additional mainfilter
- E Connection hose x 2
- F Hose connection with quick connection x 2
- G End cap
- H Power cord



3. Safety instuction

The unit must not be exposed to temperatures exceeding 50° C, open flames or condensated solvents.

Switch off the filter unit when changing filter.

4. Put into operation

Beauty Line No 1:

Mount the extraction arm (B) on facultative hose connection (F). Place the end cap (G) on the other hose connection (F). Mount the nozzle (C) on the extraction arm (B). Connect the power cord (H) to the filter system (5).



NOTE! The unit may dust some from the main filter after transportation. Make sure the starting of the unit is made in an appropriate room.

Place the extraction arm on the work bench. It is important that the extraction arm has the correct position on the table, see under headline 5 "Management".

Switch on the filter unit (5). Remote control for start/stop functions and speed of the blower is an accessorie.

Beauty Line No 2:

Mount as No 1 but with extraction arms (B) on both of the hose connections (F). Save the end cap (G) and use it if only one extraction arm is mounted on the filter system.



Beauty Line No 1

9. Technical Data - Beauty Line

| | |
|---------------------------------------|---|
| Width x height x depth | 460 x 621 x 227 mm |
| Weight | 19 kg |
| Sound level, at 1 m | 38 - 49 dB(A), depending on the speed of the blower |
| Voltage | 100/240V, 50/60Hz |
| Effect | 100 watt |
| Glass tube fuse | 2 x 6,3 AT, 250 V |
| Maximum suction capacity | 100 m ³ /h |
| Micro filter - Separation degree, DOP | >99,97 % |
| Gas filter - Separation degree | >95 % |
| Filter monitoring system | Yes |
| Warranty (excl. filter) | 2 years |
| ESD approval, SP Dno | 230-05-0189 |
| CE-guidelines | 73/23, 89/336, 89/392, 91/368, 92/31, 93/44, 93/68 |
| RoHS | Yes from 2006-07-01 |

10. Article number

| | |
|---|----------|
| Filter system Beauty Line No 1 | 950-1021 |
| Filter system Beauty Line No 2 | 950-1022 |
| Filter system Beauty Line No 3 | 950-1023 |
| Filter system Beauty Line No 4 | 950-1024 |
| Mainfilter Beauty Line | 950-2021 |
| Extraction arm 0F10 | 0F10 |
| Extraction arm 3415 | 3415 |
| Extraction arm 3046 | 3046 |
| Nozzle N | N |
| Nozzle ALFA, transparent, plastic nozzle | Alfa-T |
| Connection hose with quick connection L=1500 mm | 950-3024 |
| Remote control with cable | 700-3057 |

7. Maintenance and service

Change the filter when the alarm is heard or when the smell breaks through.

1. Switch of the circuit breaker (5)
2. Pull the front of the unit (3) straight up. Remove it from the unit.
3. Pull the hose connections (1) straight up.
4. Take away the filter (4).
5. Mark the new filter with the date of change.
6. Mount the new filter and push down the hose connections as far as possible.
7. Put the front back.

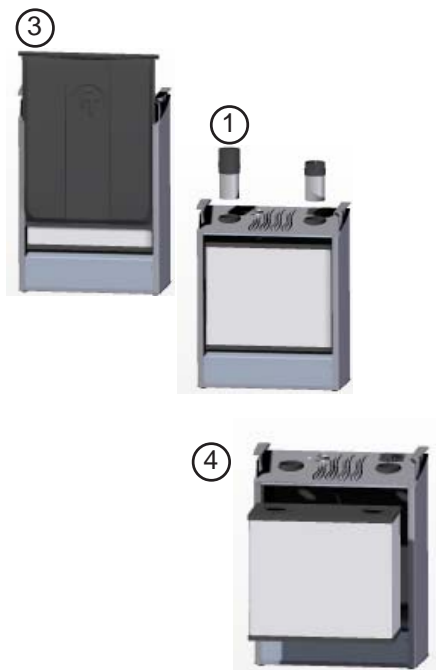

To guarantee a satisfactory function clean the nozzle and hose connection regularly.

When a new main filter is mounted, the filter monitoring needs to be set to zero:

1. Switch of the circuit breaker (5).
2. Switch on the power at the same time as the buttons (6) and (10) are pressed down. A ready signal sounds and the LED indicators die down.
3. Release the buttons, wait five seconds, switch of the circuit breaker.
4. Wait five seconds, switch on the circuit



Beauty Line No 3:

Mount the extraction arm (A) on the workbench, thread the clamps through the rectangular holes in the holding sheet and fasten them at the table edge. Mount the nozzle (C) on the extraction arm (A). Mount the connection hose (E) between facultative hose connection (F) and the extraction arm (A). Place the end cap (G) on the other hose connection (F). Connect the power cord (H) to the filter system (5).



NOTE! The filter system may dust some from the main filter after transportation. Make sure the starting of the unit is made in an appropriate room.

Place the extraction arm on the work bench. It is important that the extraction arm has the correct position on the table, see under headline 5 - Management. Switch on the filter unit (5). Remote control for start/stop functions and speed of the blower is an accessory.

Beauty Line No 4:

Mount as No 3 but with mount connection hoses (E) on both hose connections (F). Save the end cap (G) and use it if only one extraction arm is mounted on the filter system.



Beauty Line No 3

5. Management

The nozzle can be placed over or along the workbench. Filtronic recommend that the nozzle comes from the side-ways to get the best capturing area.

When grinding the nails, place the nozzle as close as possible to the hand to amount the particles to escape in the room.

When using liquids, place the nozzle 7-8 cm from the open cans. If you place the nozzle too close to the cans more liquids consumes then necessary. Even the filter will be used faster. 7-8 cm is enough to catch the gases.

NOTE! Napkins or small cans can be sucked into the arm if they are placed too close to the nozzle.

The blower capacity is preset on the maximum speed. This can be changed on the control panel, push button (6) and (10).



6. Troubleshooting



Do not modify the filter system. Repairs must be performed by personnel trained by Filtronic.

- If the filter system is out of order, please check that:
 - the electricity supply is connected in a correct way.
 - the fuse 6,3 AT is whole.

- If yellow indicator (8) flashes:

Recommended filter lifetime is exceeded.

See "Exchange of main filter" under headline 7 "Maintenance and service".

- If red indicator (7) flashes and alarm is heard:

Inferior suction capacity.

Restore the alarm by push the button "increase" (10) on the control panel. Switch of the filter system. Check that neither the extraction arm or the nozzle is covered, clean if necessary. If the alarm remains, change the main filter. See "Exchange of main filter" under headline 7 "Maintenance and service".

If the alarm not is taken care of, the filter system will stop within five minutes to protect against overheating.

NOTE! The alarm is connected to the particle filter. If the gas filter is consumed before the particle filter, which is most common in nail salons, the filter will not alarm, instead the smell from the products will break through and in that way indicate that the filter shall be exchanged.

The main filter should be changed at least once a year to guarantee the separation degree on gases.