



Filter Systems

ASSEMBLING-& OPERATING MANUAL

CBC-A

Air curtain cabinet

FOR BETTER WORKBENCH ENVIRONMENT



Filter Systems

FILTRONIC AB

Hissgatan 2, Box 2284, SE-531 02 LIDKÖPING

Tel: +46 510 208 10, Fax: +46 510 201 40

e-mail: office@filtronic.se

www.filtronic.se

Version 10
05.12.2007



Table of contents

1.	Introduction	2
2.	Content	2
3.	Safety instruction	3
4.	Assembly instruction	3-7
5.	Put into operation	8
6.	Management	9
7.	Troubleshooting	9
8.	Technical data	10
9.	Article number	10
10.	Warranty	11

1. Introduction

CBC-A air curtain cabinet creates a clean working environment on the workbench.

A unique air curtain separates the operator from the process, giving unlimited accessibility on the workbench. The air curtain cabinet stands directly on the workbench and can be used for a variety of applications, such as laboratory work, soldering and gluing.

Connect the CBC-A to mobile filter units from Filtronic AB for low running costs and high mobility. The air curtain can also be connected to the central ventilation.

2. Content

- 1 Inner gable right
- 2 Outer gable right
- 3 Frame
- 4 Front cap
- 5 Air curtain gear (2 pcs)
- 6 Lower backrail
- 7 Inner gable left
- 8 Outer gable left
- 9 Back panel
- 10 Top cover
- 11 Power cord

Screw set consisting of:

- 12 Gable distance (2 pcs)
 - 13 Screw M6 (6 pcs)
 - 14 Barrel nut (8 pcs)
 - 15 Screw with nut M4 (2 pcs)
- Mounting tools

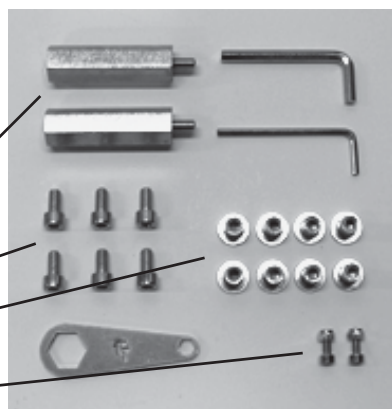

10. Warranty

General conditions according to ORGALIME S 2000.

Filtronic AB guarantees the product for manufacturing failures for a time period of two (2) years on filter units and accessories, consumptions not enclosed. The time is measured from date of invoice.

Only use genuine Filtronic AB consumables and spare parts in order to ensure reliable function and to maintain the unit's warranty. Repairs must be performed by personnel trained by Filtronic AB.

The information given is not binding and does not free the user from his or her responsibility to check the equipment before using it.

Filtronic AB reserves the right to introduce technical changes in the course of product development.

Always contact the supplier before return a product.

The invoice has to be shown at the time of the complaint.

8. Technical data CBC-A

Width x height x depth, internally	1120 x 538 x 580 mm
Width x height x depth, externally	1275 x 625 x 760 mm
Weight	53 kg
Sound level at 1 m, 200 m ³ /h	49 dB(A)
Power	110/240 V 50/60 Hz
Effect, excl. lighting	5 watt
Glass tube fuse	5x20 6,3 AT/250V
Tube lighting (cold day light, colour temp 6500)	T5 39W/865
Extracted air volume	min. 180 - max. 230 m ³ /h
Bench area required, minimum	1200 x 750 mm + 50 mm free area behind the cabinet
Warranty	2 years

9. Article number

CBC-A-112-G02-G65-I2	Model CBC-A-112, with flourescent tube lighting, ESD-safe. Cabinet supplied with sheet top cover with one Ø160 mm connection (G02), sheet backside panel (G65) and tube lighting (I2).
CBC-A-112-G04-G65-I2	Model CBC-A-112, with flourescent tube lighting, ESD-safe. Cabinet supplied with sheet top cover with 4 connections to fit 2 x MG100S (G04), sheet backside panel (G65) and tube lighting (I2).
CBC-A-112-G04-G70-I2	Model CBC-A-112, with flourescent tube lighting and backpanel in transparent plexiglas. Not ESD-safe. Cabinet supplied with sheet top cover with 4 quick to fit 2 x MG100S (G04), backpanel in transparent plexiglas (G70) and tube lighting (I2).
CBC-A-112-G22-G70	CBC-A-112, transparent model. Not ESD-safe. Please note: Can not be delivered together with lighting. Cabinet supplied with topcover in transparent plexiglas with one Ø160 mm connection (G22), backpanel in transparent plexiglas (G70).
G65	Back panel in sheet 1160x600x1,25 mm, ESD-safe.
G70	Back panel in transparent plexiglas, 1160x600x3 mm, not ESD-safe.
G80	Back panel transparent polycarbonate, 1160x600x3 mm, ESD-safe.
G02	Top cover in sheet 1160x580x1,25 mm with one Ø 160mm connection, ESD.
G04	Same as G02 but with 4 quick connections to fit 2 x MG100S.
G22	Top cover in transparent plexiglas 1160x580x3 mm with Ø 160 mm connection, not ESD-safe.
G24	Same as G22 but with 4 quick connections to fit 2 x MG100S.
G32	Top cover in transparent polycarbonate, 1160x580x3 mm with Ø 160 mm connection, ESD-safe.
G34	Same as G32 but with 4 quick connections to fit 2 x MG100S.
H02	Silencer Ø 160 mm. Length 1000 mm.
H04	Barrel nipple Ø 160 mm.

3. Safety instructions

The CBC-A must not be exposed to a temperature over + 50°C, open fire or to condensed solvents.

4. Assembling instructions

Mount the left inner gable (7) on the frame (3), as shown in the picture, with 3 pcs M6 screws (13) and 1 pc gable distance (12). NOTE! Three distances are pre-assembled on each gable.

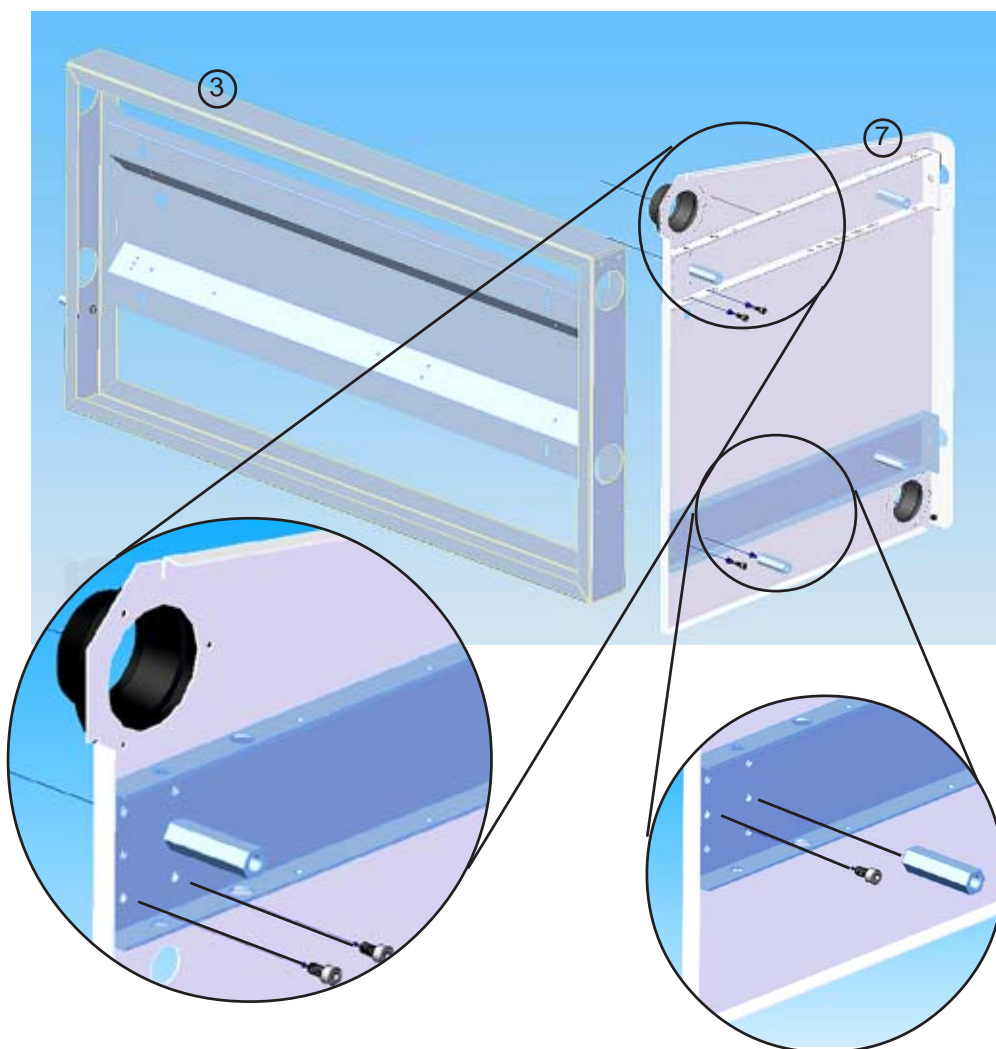

Mount the air curtain gear (5) and fasten the right inner gable (1) in the same way as the left gable.

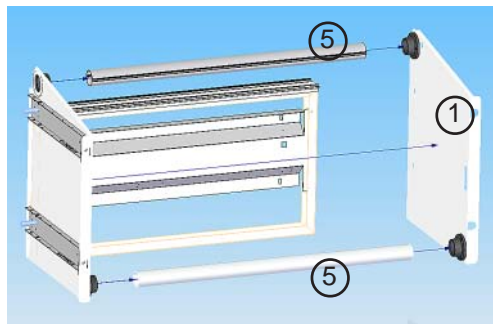

Mount the lower backrail (6) with 2 pcs M4 screw with nut (15) in the track at the very bottom of the inner gables.

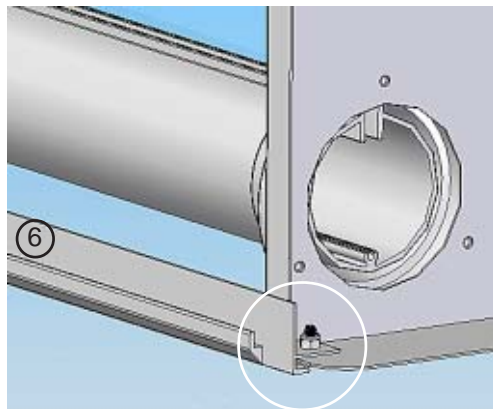

Put the cabinet on its feet and adjust them until the cabinet stands stable. Max. adjustment 10 mm.



OBS! Do this before mounting the outer gables as the nuts need to tighten.

Loosen the cables fastened at the right inner gable and thread them through the rubber bussing at the right inner gable.



6. Management

Do not place the CBC-A in draught, for example near doors, windows or supply air diffuser, as this can interrupt the air curtain.

Keep your head outside the air curtain.

The working object should be placed approx. 50 mm inside the cabinet.



Blue = Clean air Yellow = Polluted air

7. Troubleshooting

Do not modify the air curtain cabinet. Repairs must be done by certified personnel.

If the CBC-A does not work, check the following:

- the electricity supply is connected in a correct way.
- the fuse is whole. It is placed beside the power supply.
- the cabinet is placed according to the instructions.
- extracted air volume is correct.

5. Put into operation

Place the air curtain cabinet on the workbench, app. 100 mm from the front edge at the table board. Minimum size of the table is 750x1200 mm. 50 mm free space is required behind the cabinet.

Connect the air curtain cabinet to the suction source.

NOTE! Necessary air volume is min. 180 and max. 230 m³/h.

Connect the power cord (11) at the back of the cabinet.



Switch on the cabinet with the on/off switch.



Power supply for connection of external power supply consumers.



Put the cable under the white cables and through the rubber bussing.



Thread the double end of the cable into the hole at the front supporting leg and connect the socket to the upper blower.



Thread the single end of the cable into the hole at the back supporting leg and connect the lower blower.

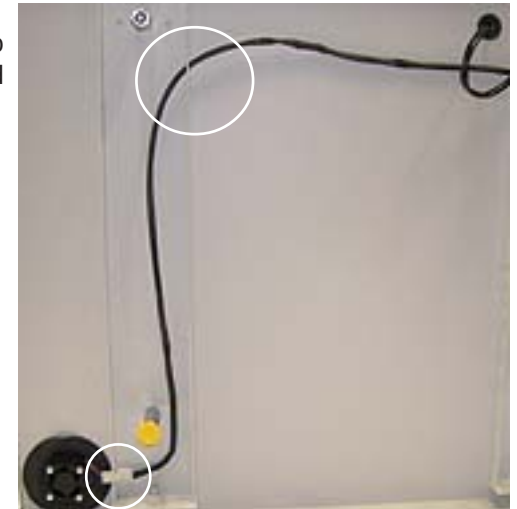

Thread the cable from the tube lighting through the back hole in the left gable and mount the rubber bussing.



Connect the socket.

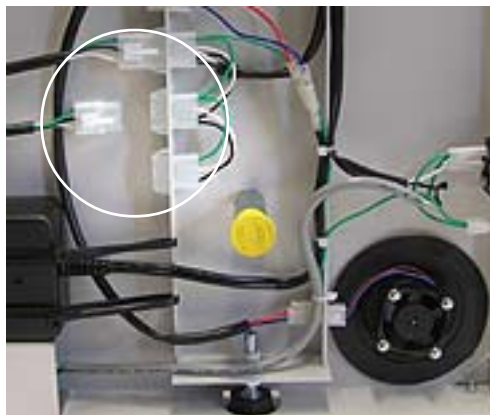

Mount the top cover (10)...

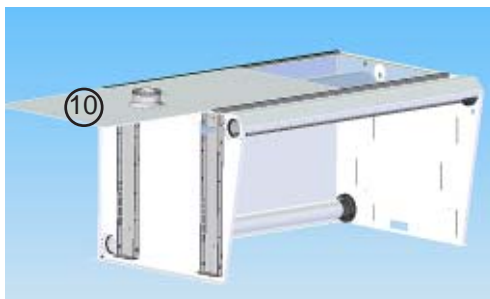

... and back panel (9) by slide them in the tracks.

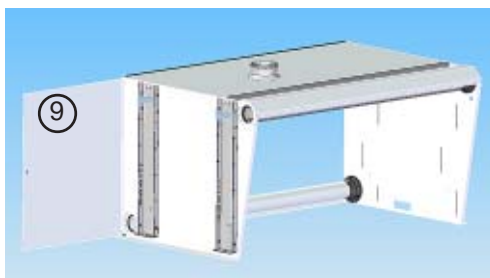

Mount the front cap (4) by placing it in the upper track. Bow the cap slightly and press it in the lower track.

It is important that the cap is placed in both tracks.

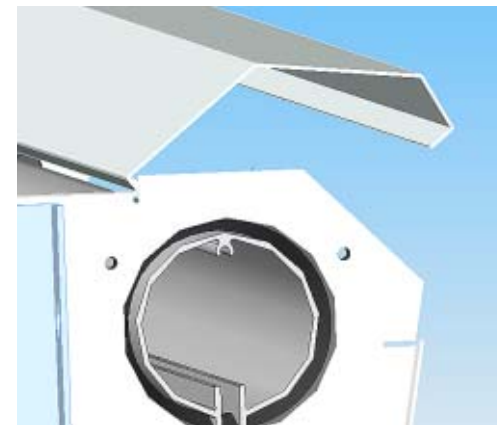

Remove the yellow protection from the distances and mount the outer gables (2, 8) with 4 pcs barrel nuts (14) on each side.

Make the mounting easier by fasten the barrel nuts slightly and tighten them when all are in its place.



The assembly is completed.

