



OPERATING MANUAL

MP140

Filter system

FOR A BETTER WORKBENCH ENVIRONMENT



FILTRONIC AB
Hissgatan 2, Box 2284, 531 02 LIDKÖPING
Tel: +46 510 208 10, Fax: +46 510 201 40
e-mail: office@filtronic.se
www.filtronic.se

Version 1
2009.05.11



Content

1.	Introduction	2
2.	Content	2
3.	Safety instructions	3
4.	Put into operation	3
5.	Troubleshooting	3-4
6.	Maintenance and service	4
7.	Accessories	5
8.	Technical data	6
9.	Article number	6
10.	Warranty	7

1. Introduction

MP140 is a highly effective filter system for elimination of polluted air at the workbench. MP140 is designed for applications with a large amount of particles.

2. Content

1. Hose connections
2. Top
3. Main filter
4. Control panel
5. Power intake with fuse and circuit breaker

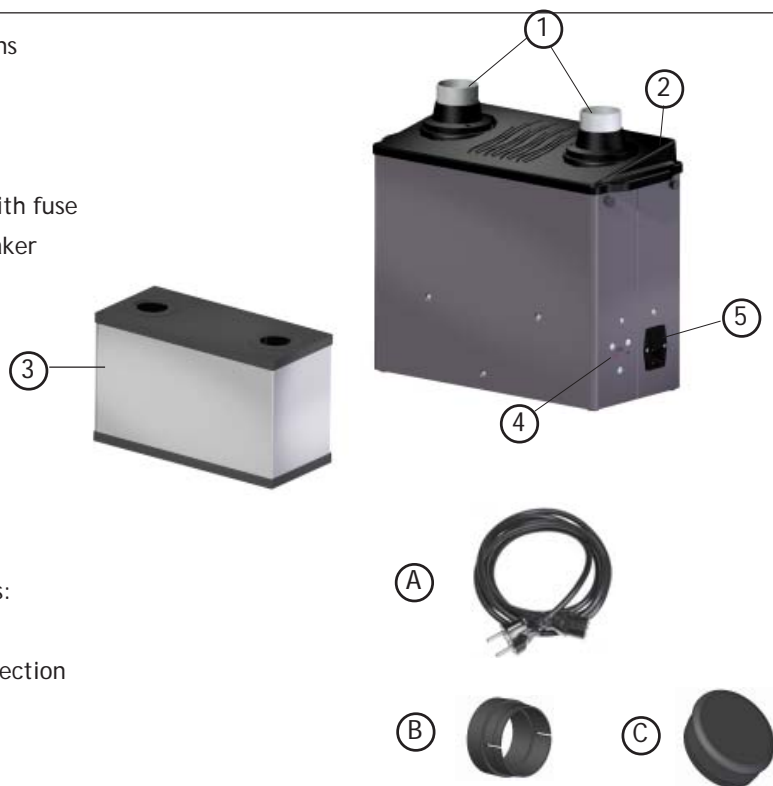

Connection details:

- A. Power cord
- B. Quick-connection
- C. End cap

10. Warranty

General conditions according to ORGALIME S 2000.

Filtronic guarantees the product for manufacturing failures for a time period of two (2) years on filter units and accessories, consumptions not enclosed. The time is measured from date of invoice.

Only use genuine Filtronic consumables and spare parts in order to ensure reliable function and to maintain the unit's warranty. Repairs must be performed by personnel trained by Filtronic AB.

The information given is not binding and does not free the user from his or her responsibility to check the equipment before using it.

Filtronic reserves the right to introduce technical changes in the course of product development.

Always contact the supplier before returning a product.
The invoice has to be shown at the time of the complaint.

8. Technical data

Width, mm (in)	420 (16,5)
Height, mm (in)	440 (17,3)
Depth, mm (in)	200 (7,8)
Weight, kg (lb)	8 (17,6)
Sound level at 1 meter	<54 dB(A)
Voltage	100-240 V, 50-60 Hz
Effect	100 watt
Glass tube fuse	2 x 6,3 AT, 250 V
Maximum suction capacity, m ³ /h (CFM)	100 (58,8)
Blower capacity, m ³ /h (CFM)	140 (82,3)
Micro filter - Separation degree, MPPS	>99,95 %
Filter monitoring system	Yes
Warranty (excl. filter)	2 years
ESD approval, SP Dno	230-05-0189
CE-guidelines	73/23, 89/336, 89/392, 91/368, 92/31, 93/44, 93/68
RoHS	Yes

8. Article number

Filter system MP140	140-1000-ESD
Replacement filter	140-2000-ESD
MP140 kit 1	140-1011-ESD
MP140 kit 2	140-1012-ESD
MP140 kit 3	140-1013-ESD

3. Safety instructions

The unit must not be exposed to temperatures exceeding 50° C, open flames or condensated solvents.

Switch off the filter unit when changing filter.

4. Put into operation



NOTE! The unit may dust some from the main filter after transportation. Make sure the starting of the unit is made in an appropriate room.

Place the filter system on the floor or hang it on the workbench with mounting device, see under headline 7 - Accessories. Connect the power cord and switch the circuit breaker (5).

5. Troubleshooting



Do not modify the filter unit. Repairs must be performed by personnel trained by Filtronic.

- If the filter unit is out of order, please check:
 - the electricity supply is connected in a correct way.
 - the fuse is intact.

- If alarm sounds when starting and red indicator **flashes**:

Recommended filter lifetime is exceeded. Indicates exchange of main filter. Restore the alarm with the reset button on the control panel and plan for filter exchange. See "Exchange of main filter" under headline 6 "Maintenance and service".

- If alarm sounds when starting and red indicator is **lighted**:

Suction capacity is low. Restore the alarm with the reset button on the control panel and switch off the filter unit. Check nozzles and tubes, clean if necessary. If the alarm comes back when starting, the filter is used and must be changed. See "Exchange of main filter" under headline 6 "Maintenance and service". If no action is taken, the filter unit stops after five minutes to protect the unit from overheating.

The main filter should be changed at least once a year to guarantee the separation degree on particles.

6. Maintenance and service

To guarantee a satisfactory function, clean the nozzle, extraction arm and connection hose regularly.

Exchange of main filter:

- Switch off the filter unit (5).
- Loosen the top (2) with the four knobs on the short sides of the unit. Lift the top straight up.
- Pull the main filter straight up.
- **NOTE!** The new filter has to be marked with the date of change
- Mount a new filter. Make sure that the inlet to the fan fits to the connection in the bottom of the filter.
- Put the top back.

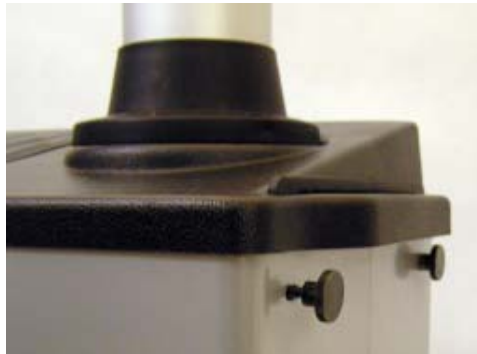

When changing the main filter, the filter time is set to zero by keeping the reset button pressed and switch on at the same time.

NOTE! The reset button must be pressed until the red light-emitting diode acknowledge the order.

7. Accessories - MP140 kit

MP140 kit 1

Mount the bench mounting bracket on the workbench with the clamps (D). Mount the connection hose (E) between the bench mounting bracket (D) and the filter system. Mount the flexible arm (F) between the bench mounting bracket (D) and the nozzle (G). Connect the power cord to the filter system.



MP140 kit 2

Mount the bench mounting bracket on the workbench with the clamps (D). Mount the connection hose (E) between the bench mounting bracket (D) and the filter system. Mount the flexible arm (F) between the bench mounting bracket (D) and the nozzle (G). Connect the power cord to the filter system.

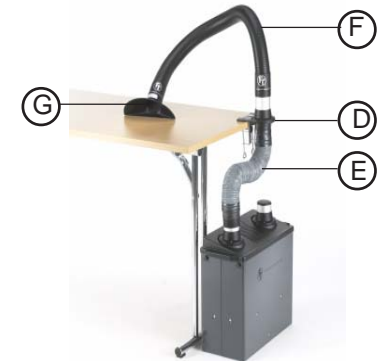

MP140 kit 3

Mount the table mounting set (H) on the workbench. Place the filter system in the table mounting set. Mount flexible arms (F) on both hose connections and then nozzles (G) on the flexible arms (F). Connect the power cord to the filter system.

